

# POSTERBOX SLIM 2



## Installation Guide for 701946-(X)WXL3

**WARNING:** Risk of electrical shock. New installation and LED Retrofit Kit installation requires knowledge of sign electrical systems. If not qualified, do not attempt installation. Contact a qualified electrician. Follow all NEC and local codes. PosterBOX Slim 2 is not suitable for submersion or direct exposure to water for extended periods of time. **AVERTISSEMENT:** Risque de choc électrique. La nouvelle installation et l'installation du kit de modification à LED nécessitent la connaissance des systèmes électriques de signalisation. Si non qualifié, ne tentez pas l'installation. Contactez un électricien qualifié. Suivez tous les codes NEC et locaux. PosterBOX Slim 2 ne convient pas à la submersion ni à l'exposition directe à l'eau pendant de longues périodes.

**For New Installation, proceed with Step 1 below. For Retrofit Installations, begin with Retrofit Instructions on page 2.**

## New Installation

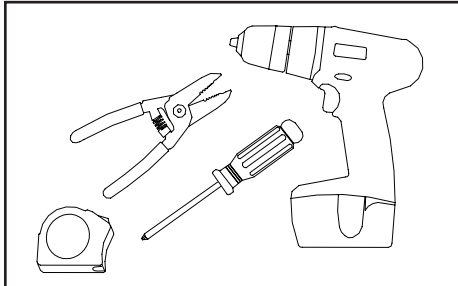

### Recommended tools:

- Measuring tape
- Drill
- Wire strippers
- Screwdriver

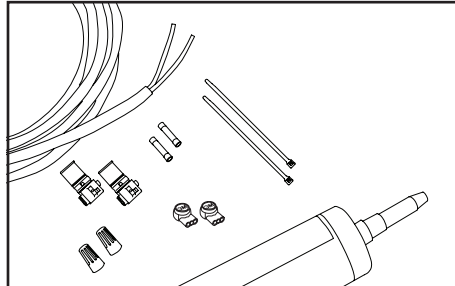

### Components list:

- PosterBOX Slim 2 modules, model number 701946-(X)WXL3
- 12 V Class 2 output power supply
- Optional: UL approved 18 AWG, or larger diameter supply wire
- UL approved wire connectors appropriate for wire gauge used
- Optional for mounting: Electrical grade silicone, #8 sheet metal screws, or 5/32" aluminum rivets

## Layouts

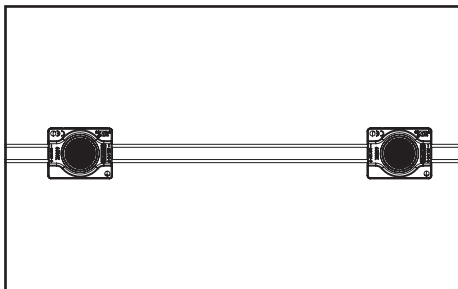

**NOTE:** For best results, space modules at two per foot. For best performance in a single-sided sign box, mount modules on returns, flush against rear wall of box. For a double-sided sign box, mount modules in center of returns.

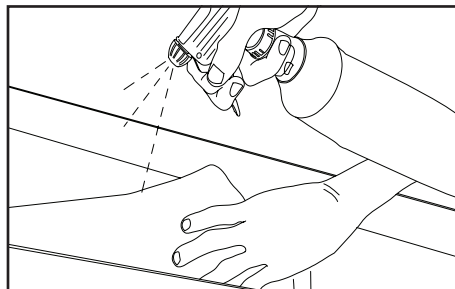

**1. Clean surface:** Clean inside of sign box with rubbing alcohol and allow to dry. Clean all mounting surfaces with alcohol for proper tape adhesion.

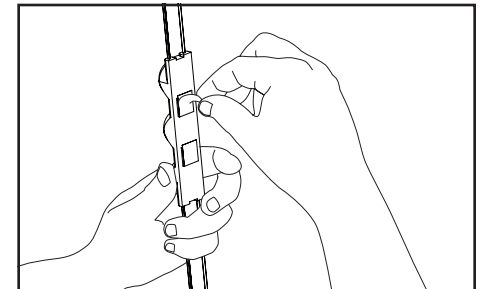

**2. Peel and stick:** Using provided double stick tape, mount PosterBOX Slim 2 modules to sides of sign box.

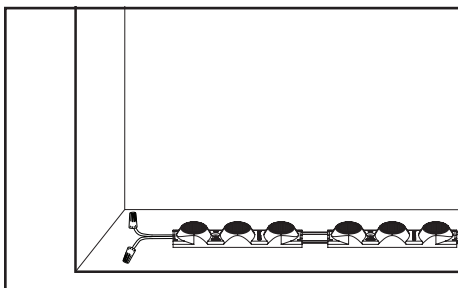

**WARNING:** Check Polarity – All connections must be RED-TO-RED (+) and BLACK-TO-WHITE (-). Reverse polarity connections may damage the LEDs and will void product warranty. **AVERTISSEMENT:** Vérifiez la polarité - Toutes les connexions doivent être ROUGE-ROUGE (+) et NOIR-BLANC (-). Des connexions inversées peuvent endommager les DEL et annuler la garantie du produit.

**3. Fasteners:** If desired, modules can be secured to sides of sign box using #8 pan head sheet metal screws or 5/32" aluminum rivets.

# POSTERBOX SLIM 2



## Installation Guide for 701946-(X)WXLP3

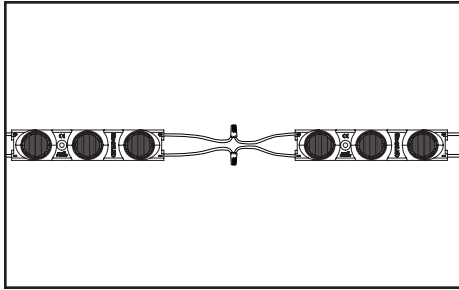

**4. Connections:** Modules may be connected in series or parallel. Modules should not be looped to create a closed circuit. Cap all unused, exposed wire ends.

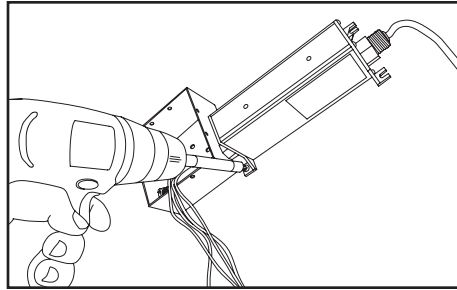

**5. Connect to power supply:** See Power Supply Installation Guide for more information regarding power supply installation. **CAUTION!** Have a licensed electrician connect primary power.

## Retrofit Instructions for Existing Signs



GENERAL PURPOSE  
RETROFIT SIGN CONVERSION.  
FOR USE ONLY IN ACCORDANCE  
WITH KIT INSTRUCTIONS.

KIT IS COMPLETE ONLY WHEN ALL PARTS  
REQUIRED BY THE INSTRUCTIONS ARE PRESENT.

**WARNING:** Risk of fire or electric shock. Install this kit only in host signs that have been identified in the installation instructions, and where the input rating of the retrofit kit does not exceed the input rating of the sign. Installation of this LED retrofit kit may involve drilling or punching of holes into the structure of the sign. Check for enclosed wiring and components to avoid damage to wiring and electrical parts.

**AVERTISSEMENT:** Risque d'incendie ou de choc électrique. Installez ce kit uniquement sur les panneaux hôtes identifiés dans les instructions d'installation et dans lesquels les caractéristiques nominales d'entrée du kit de modification ne dépassent pas celles du panneau. L'installation de ce kit d'amélioration des LED peut impliquer de percer ou de percer des trous dans la structure de l'enseigne. Vérifiez le câblage et les composants inclus pour éviter d'endommager le câblage et les pièces électriques.

**CAUTION:** Turn off power to sign before inspecting or removing existing light source. Power must remain off while installing LED product.

**ATTENTION :** Coupez l'alimentation générale du panneau avant d'intervenir ou de retirer la source lumineuse existante. L'alimentation générale doit être coupée tout au long de l'installation du kit de remplacement en LED.

1. Identify sign to be retrofit and ensure branch circuit supplying existing sign are within voltage range for LED power supply. Refer to components list (page 1) and "12 VDC Power Supply Capacity Chart" (page 3).
2. Remove existing lighting equipment intended to be replaced, such as neon or fluorescent, and all power supplies, transformers, or ballasts. Remove existing neon and all standoffs to leave an empty sign cabinet. **NOTE:** All materials removed must be disposed of in accordance with applicable local, state, and federal laws.
3. If required by local, state, or national electrical code, install a new disconnect switch.
4. Determine suitability and structural integrity of existing sign after removal of existing lighting equipment. If retrofit does not require the making of any new holes, do not make or alter any open holes in an enclosure of wiring or electrical components during kit installation. If existing holes are present in a wet or outdoor location sign, repair and seal any unused openings in the electrical enclosure. Openings greater than 0.5" diameter require a metal patch secured by screws or rivets and caulked with non-hardening caulk. Smaller openings may be sealed with non-hardening caulk.
5. Clean inside of sign using non-oil based cleaner. Follow all manufacturer's instructions and ensure inside of sign is dry before proceeding with installation. This is an important step for good adhesion of PosterBOX Slim 2 module mounting tape.
6. To populate sign, refer to PosterBOX Slim 2 density guidelines as well as power supply capacity chart (page 3) to determine appropriate number of modules and power supplies.
7. Follow all instructions on page 1 under "New Installation" to properly install LED modules.
8. Connect modules to power supply output as shown on page 1 under "New Installation".
9. Connect power supply input as outlined in power supply installation guide in accordance with local, state and national electrical codes by qualified personnel. Refer to power supply install guide included with power supply for details.
10. If required, install disconnect switch in accordance with local, state and national electrical codes by qualified personnel.

# POSTERBOX SLIM 2



Installation Guide for 701946-(X)WXL P3

## 12 VDC Power Supply Capacity Chart

Power Output	Maximum modules
60 W	32
2 × 60 W	2 × 32
Power used per module in Watts:	1.68 W

\*Combination of units must not exceed maximum power supply output.  
Capacities based on 90% of power supply output.

## Extension of Power Supply Leads

If longer lead wire from power supply to LED product is needed, an extension can be used. Extension should be kept as short as possible, i.e., under 15 ft use 18 AWG UL Listed PLTC or under 50 ft use 14 AWG UL Listed PLTC.

## Troubleshooting

**NOTE:** A licensed electrician should perform all applicable steps.

<b>Entire box or leg does not light after complete installation.</b>	Check connection from power supply lead to first module. Make sure polarity of connections made at the power supply lead between modules and any jumper wire is correct. All connections must be RED-to-RED and BLACK-to-WHITE.
<b>Still does not light.</b>	Check output voltage of power supply using a multimeter. The output voltage should be 12.0 VDC ± 0.5 VDC. If there is no output voltage, have a licensed electrician check input voltage. Make sure power supply is connected correctly and getting primary power. If power supply is connected properly and getting primary power and there is still no output voltage, try a different power supply.
<b>Still does not light.</b>	If power supply is getting primary power and modules don't light, there may be a short in secondary wiring. Check all connections and cap all loose wires.
<b>The beginning of a leg lights, but entire leg does not light or lights intermittently.</b>	The primary cause of a portion of a PosterBOX Slim 2 leg not lighting or lighting intermittently is a bad connection or reverse polarity connection between modules that light and modules that don't light. Check this connection.
<b>One module does not light, but all others in leg light.</b>	PosterBOX Slim 2 is designed so if one module fails, it will not cause the entire sign or leg to go out. If one module does not light, but all others in the leg do, replace this module with a new one.

The PosterBOX product family is licensed by Signify (formerly Philips Lighting) in relation to the following patents: North America: US7841733. Europe: EP1938298, NL1030161, NL2000273, DE202006020673.6. Asia: CN101300616. PosterBOX products are licensed under Signify's Enabled program when bought as a PosterBOX lighting kit solution including a Principal Sloan power supply. Final application in which PosterBOX lighting kit solution is installed is covered by Principal Sloan's licensing agreement with Signify and free from any further royalties relating to the patents listed above.



### Customer service and technical support

- principalsloan.com
- 325.227.4577
- 3490 Venture Dr., San Angelo, TX 76905

