

# STREET WRAP™ FLEX MINI

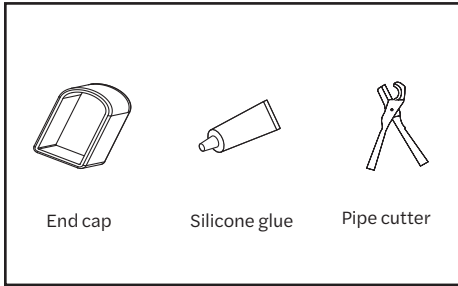

## Cutting and Sealing



### Installation tools & components

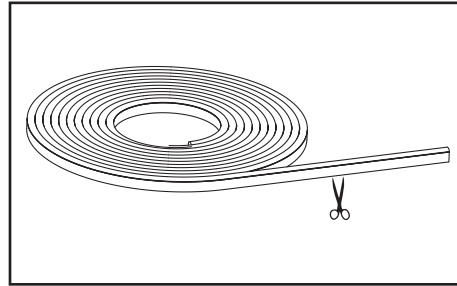

1. The first cut for this product can be a minimum of 2". If you wish to have additional length, then the cut sections would be every 0.3280" after the first 2" length. To ensure accurate cuts; connect the product to a 12 VDC power supply, turn on the product, and make your desired cut mark between two lit LED locations on the bottom side of the product. Before cutting, disconnect the strip from the power supply to prevent shorting.

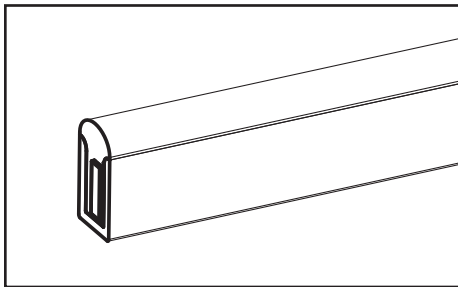

2. Clean cut end before next steps.

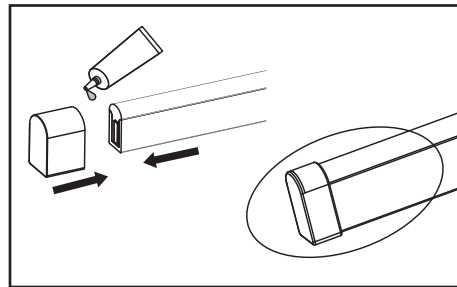

3. Coat end cap with silicone glue and install.

### CAUTION

Do **NOT** twist and bend this product abruptly or severely.



This action may cause copper trace or solder connections to crack, resulting in section outages along the strand.

### TAKE EXTREME CAUTION WHEN UNBOXING AND INSTALLING.

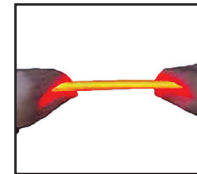

Normal flex

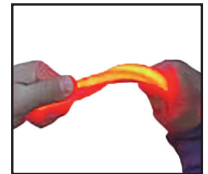

Unnatural bend

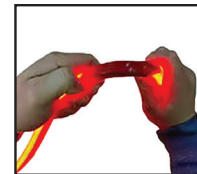

Section outage



Result of twist & bend

**Outages caused by these actions may void your warranty.**

**Unwind Flex strip from coil or reel carefully and without twisting.**

### IMPORTANT WARRANTY INFO

**This warranty is void if any cuts are made in the field. Any cuts must be made by Principal Sloan to maintain warranty.**

**NOTE:** The LED neon itself and all its components may not be mechanically stressed. Please ensure that the power supply is adequate to operate the total load. Only qualified personnel should be allowed to perform installations. The design of the housing should be according to the IP standards in the application. If surge protection structure not within power supplier, a lightning protector should be needed additionally. Before cutting and sealing, please read the user manual, and please ensure you have read and fully understand it. Please do not twist the product and do not bend it in wrong direction, see Figure 2 for a correct demonstration.

# STREET WRAP™ FLEX MINI



**Installation** Street Wrap Flex Mini can be mounted to any surface that will accommodate conventional fasteners.

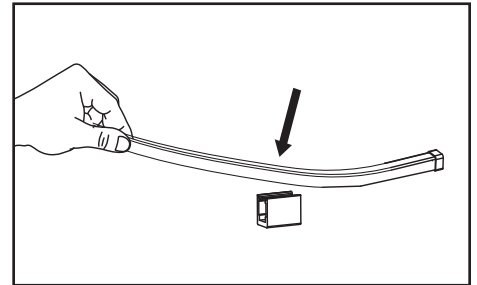
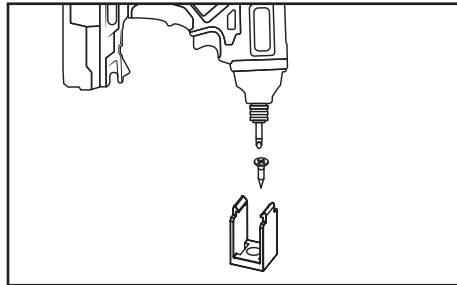
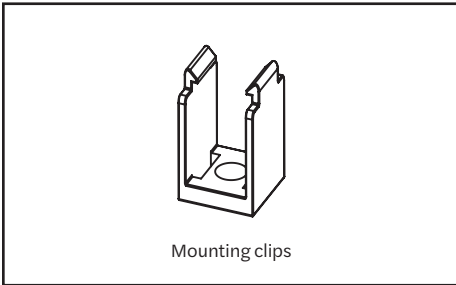

## Mounting Accessories

**1.** Place mounting clips wherever necessary to shape **Street Wrap Flex Mini** to desired contour. Fasten clips to mounting surface using #4 pan head screws or 0.125" rivets.

**2.** Gently press product into mounted clips.

## Warnings

Lighting surface

**Street Wrap Flex Mini only bends as shown above.**

Do not pull on or hold product by cable.

Do not twist or bend product at sharp angles.

**TOP VIEW**

**SIDE VIEW**

Mounting surface

**For assembly of Street Wrap Flex Mini longer than 6.6 ft:**  
Careful handling with a minimum of two (2) employees is required.

### Customer service and technical support

- principalsloan.com
- 325.227.4577
- 3490 Venture Dr., San Angelo, TX 76905

