

# SYMPHONY BILLBOARD LIGHT



## Installation Guide for Symphony Billboard Light

**NOTE:** Lockout and tagout power before installing fixture.  
**CAUTION:** Risk of electric shock



**WARNING:** ALL ELECTRICAL CONNECTIONS MUST BE PERFORMED BY A QUALIFIED LICENSED ELECTRICIAN.

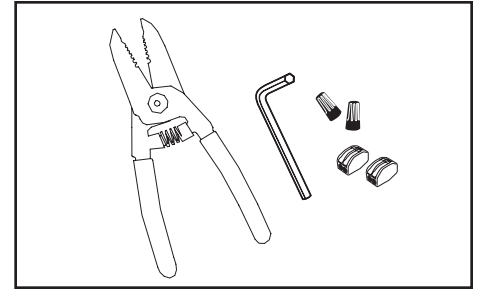

**Tools required:** UL Listed electrical connectors (wire nuts, lever nuts, etc.), 6 mm hex key, wire strippers.

## Installation

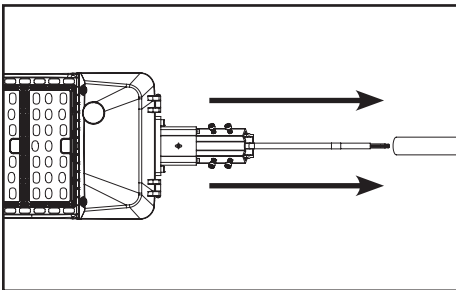

1. Loosen mounting hardware as necessary to position luminaire on 1.25" rigid conduit or 1.5" square tubing. Pull cable through mounting arm and pole for mounting.

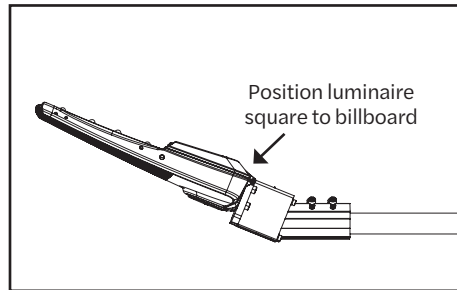

2. Ensure luminaire is fully seated against end of pole and ensure final position is square to surface to be illuminated.

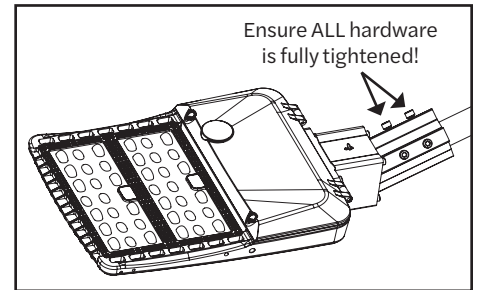

3. Tighten all mounting hardware and ensure luminaire is securely mounted.

## Wiring Diagram

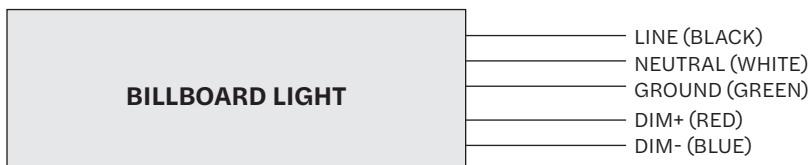

4. Connect power cable to incoming power. Ensure all connections are enclosed and installation is performed in accordance with local and national electrical codes. All electrical connections should be made by a licensed electrician.

### Customer service and technical support

- principalsloan.com
- 325.227.4577
- 3490 Venture Dr., San Angelo, TX 76905

